

C-0

SHEET:

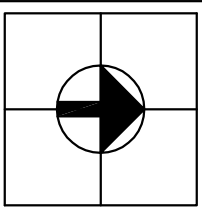
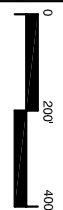

SITE PLAN

MSP REDEVELOPMENT PROJECT

JEFFERSON CITY, MISSOURI

PROJECT NUMBER: C 0020-01
 PARSONS PROJECT NUMBER: 738538

State of Missouri MATT BLUNT, GOVERNOR

Office of Administration
 Division of Facilities Management,
 Design and Construction
 David L. Mosby, CFM, Director

MSP Redevelopment Commission

Room 730, Truman Building
 P.O. Box 809
 Jefferson City, Missouri 65102

Prepared by:

PARSONS
 400 Woods Mill Road South, Suite 300
 St. Louis, Missouri 63017-3427
 In Association with:
 Development Strategies, Inc.
 Trivers Associates, Inc.
 TSI Engineering, Inc.
 William Tao & Associates, Inc.
 George Dickie Associates

DATE: November 2005

REVISIONS:

MATCHLINE SEE SHEET C-3

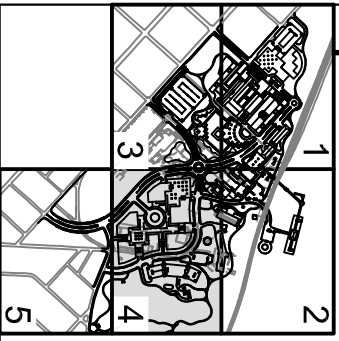

MATCHLINE SEE SHEET C-5

MATCHLINE SEE SHEET C-2

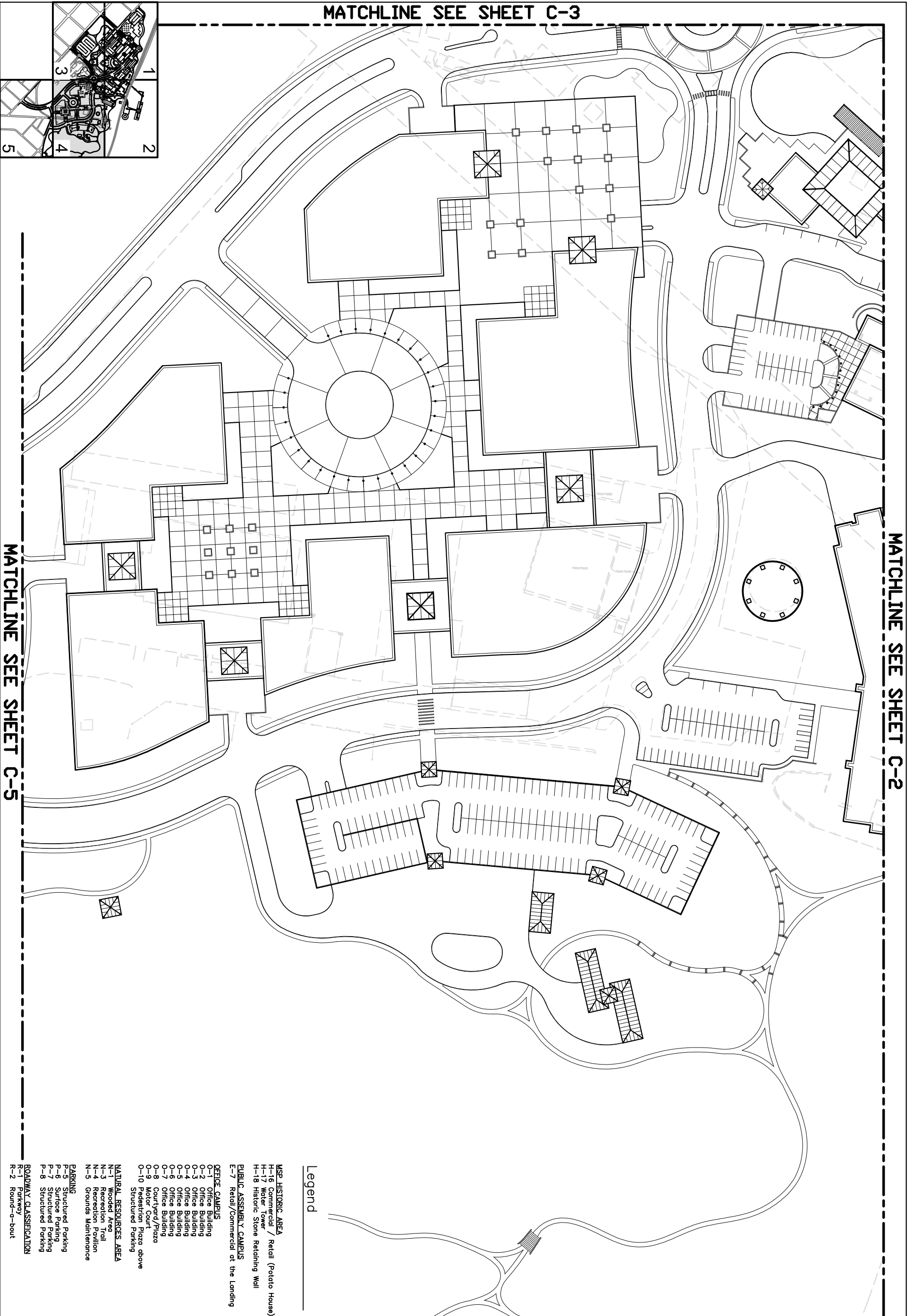

Legend

- MSP HISTORIC AREA
 - H-16 Commercial / Retail (Potato House)
 - H-17 Water Tower
 - H-18 Historic Stone Retaining Wall
- PUBLIC ASSEMBLY CAMPUS
 - E-7 Retail/Commercial at the Landing
- OFFICE CAMPUS
 - O-1 Office Building
 - O-2 Office Building
 - O-3 Office Building
 - O-4 Office Building
 - O-6 Office Building
 - O-7 Office Building
 - O-8 Courtyard/Piazza
 - O-9 Motor Court
 - O-10 Pedestrian Plaza above Structured Parking
- NATURAL RESOURCES AREA
 - N-1 Wooded Area
 - N-3 Recreation Trail
 - N-4 Recreation Pavilion
 - N-5 Grounds Maintenance
- PARKING
 - P-5 Structured Parking
 - P-6 Surface Parking
 - P-7 Structured Parking
 - P-8 Structured Parking
- ROADWAY CLASSIFICATION
 - R-1 Parkway
 - R-2 Round-about

SITE PLAN

MSP REDEVELOPMENT PROJECT
JEFFERSON CITY, MISSOURI

PROJECT NUMBER: C 0020-01
PARSONS PROJECT NUMBER: 738538

State of Missouri
MATT BLUNT, GOVERNOR
Office of Administration
Division of Facilities Management,
Design and Construction
David L. Mosby, CFM, Director
MSP Redevelopment Commission
Room 730, Truman Building
P.O. Box 809
Jefferson City, Missouri 65102

Prepared by:
PARSONS
400 Woods Mill Road South, Suite 300
St. Louis, Missouri 63017-3427
In Association with:
Development Strategies, Inc.
Trivers Associates, Inc.
TSI Engineering, Inc.
William Tao & Associates, Inc.
George Dickie Associates

DATE: November 2005
REVISIONS:

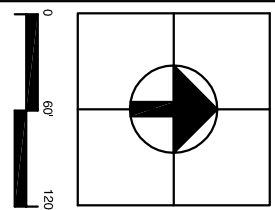

C-4

SHEET:

MATCHLINE SEE SHEET C-1

MATCHLINE SEE SHEET C-4

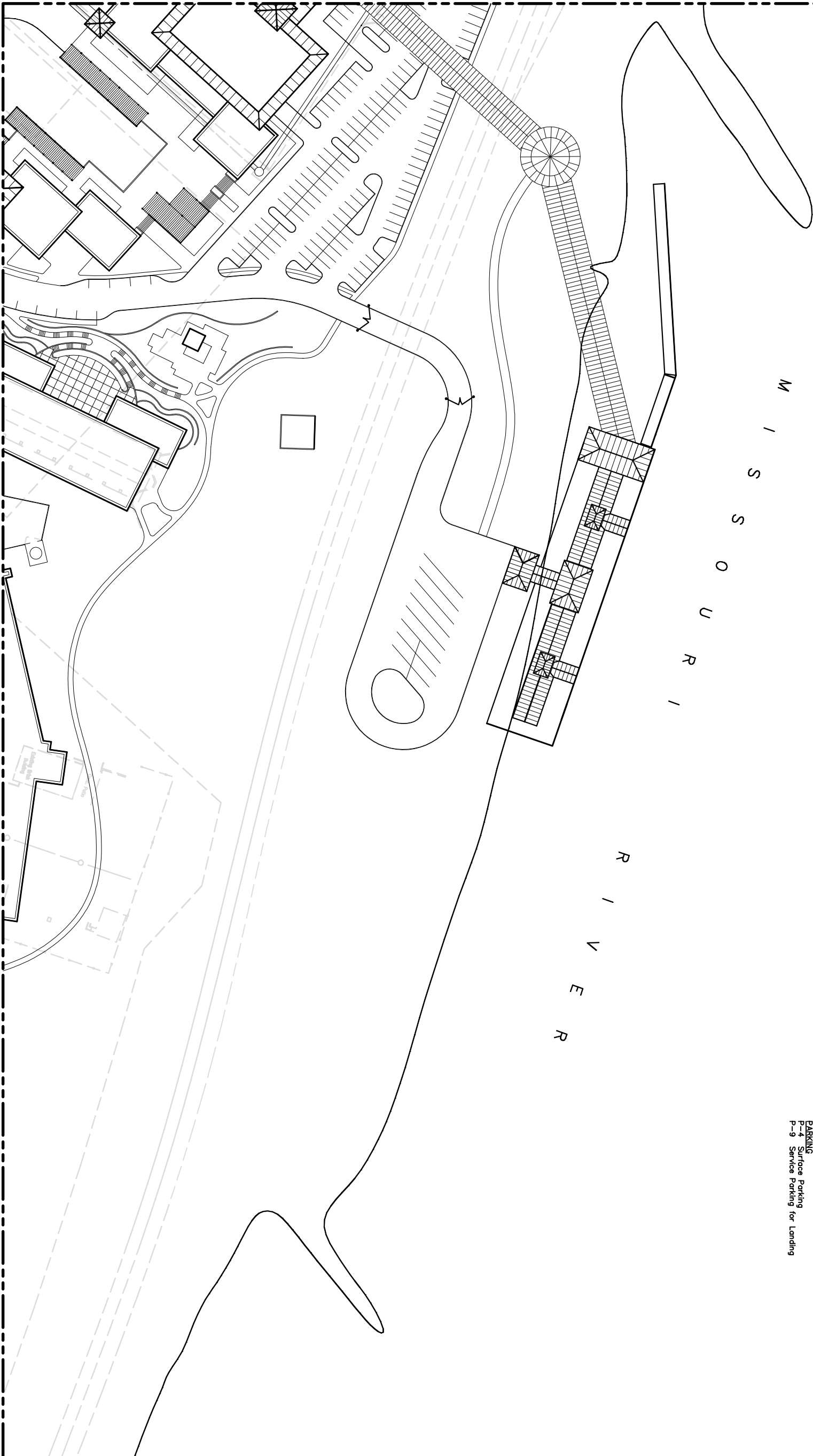

Legend

- MSP HISTORIC AREA**
- H-13 Guard Tower
- H-14 Remnant Wall
- H-15 Stoughter House Smoke Stack
- H-16 Commercial / Retail (Palato Houses)
- PUBLIC ASSEMBLY CAMPUS**
- E-3 Elevated Link to Rivers' Edge
- E-4 Excursion Boat Landing
- E-5 Hotel 3
- E-6 Water Feature and Pedestrian Plaza
- OFFICE CAMPUS**
- O-1 Office Building
- PARKING**
- P-4 Surface Parking
- P-9 Service Parking for Landing

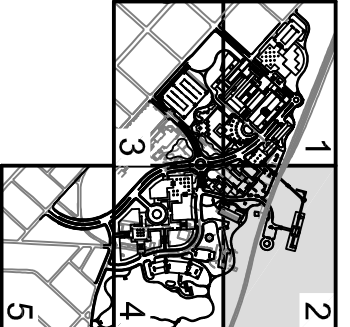

C-2

SHEET:

SITE PLAN

MSP REDEVELOPMENT PROJECT

JEFFERSON CITY, MISSOURI

PROJECT NUMBER: C 0020-01
PARSONS PROJECT NUMBER: 738538

State of Missouri MATT BLUNT, GOVERNOR

Office of Administration
Division of Facilities Management,
Design and Construction
David L. Mosby, CFM, Director

MSP Redevelopment Commission

Room 730, Truman Building
P.O. Box 809
Jefferson City, Missouri 65102

Prepared by:
PARSONS
400 Woods Mill Road South, Suite 300
St. Louis, Missouri 63017-3427

In Association with:
Development Strategies, Inc.
Trivers Associates, Inc.
TSI Engineering, Inc.
William Tao & Associates, Inc.
George Dickie Associates

DATE: November 2005
REVISIONS:

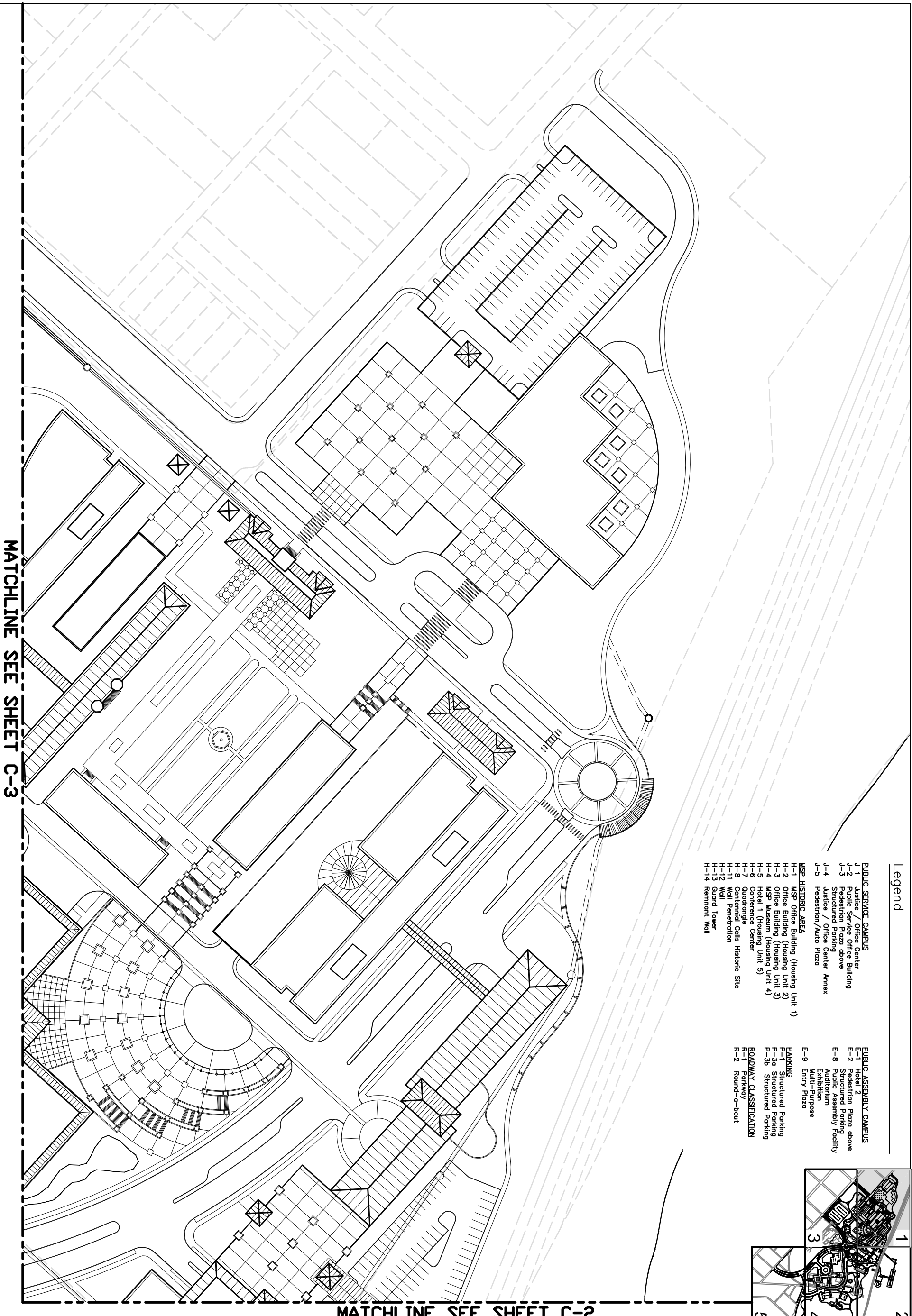

MATCHLINE SEE SHEET C-3

MATCHLINE SEE SHEET C-2

Legend

- J-1 Justice / Office Center
- J-2 Public Service Office Building
- J-3 Pedestrian Plaza above Structure
- J-4 Justice / Office Center Annex
- J-5 Pedestrian/Auto Plaza
- MSP HISTORIC AREA**
- H-1 MSP Office Building (Housing Unit 1)
- H-2 Office Building (Housing Unit 2)
- H-3 Office Building (Housing Unit 3)
- H-4 MSP Museum (Housing Unit 4)
- H-5 Hotel 1 (Housing Unit 5)
- H-6 Conference Center
- H-7 Gateway
- H-8 Gateway Calls Historic Site
- H-11 Wall Penetration
- H-12 Wall
- H-13 Guard Tower
- H-14 Remnant Wall
- PUBLIC ASSEMBLY CAMPUS**
- E-1 Hotel 2
- E-2 Pedestrian Plaza above Structure
- E-3 Structured Parking
- E-4 Public Assembly Facility
- E-5 Exhibition
- E-6 Multi-Purpose
- E-7 Entry Plaza
- PARKING**
- P-1 Structured Parking
- P-2 Structured Parking
- P-3a Structured Parking
- P-3b Structured Parking
- ROADWAY CLASSIFICATION**
- R-1 Parkway
- R-2 Round-about

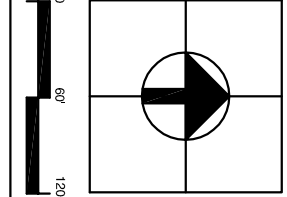
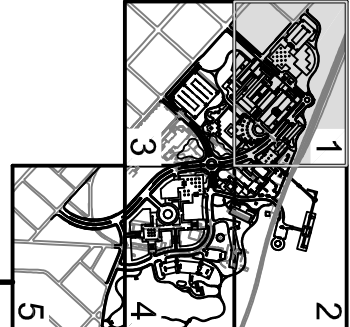

SITE PLAN
 MSP REDEVELOPMENT PROJECT
 JEFFERSON CITY, MISSOURI
 PROJECT NUMBER: C 0020-01
 PARSONS PROJECT NUMBER: 738538

State of Missouri MATT BLUNT, GOVERNOR
 Office of Administration
 Division of Facilities Management,
 Design and Construction
 David L. Mosby, CFM, Director
 MSP Redevelopment Commission
 Room 730, Truman Building
 P.O. Box 809
 Jefferson City, Missouri 65102

Prepared by:
PARSONS
 400 Woods Mill Road South, Suite 300
 St. Louis, Missouri 63017-3427
 In Association with:
 Development Strategies, Inc.
 Trivers Associates, Inc.
 TSI Engineering, Inc.
 William Tao & Associates, Inc.
 George Dickie Associates

DATE: November 2005
 REVISIONS:

C-1

SHEET:

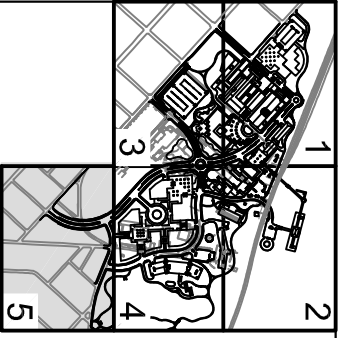

Legend

ROADWAY CLASSIFICATION
 R-1 Parkway
 R-3 Secondary Roadway
 NATURAL RESOURCES AREA
 N-4 Recreation Pavilion

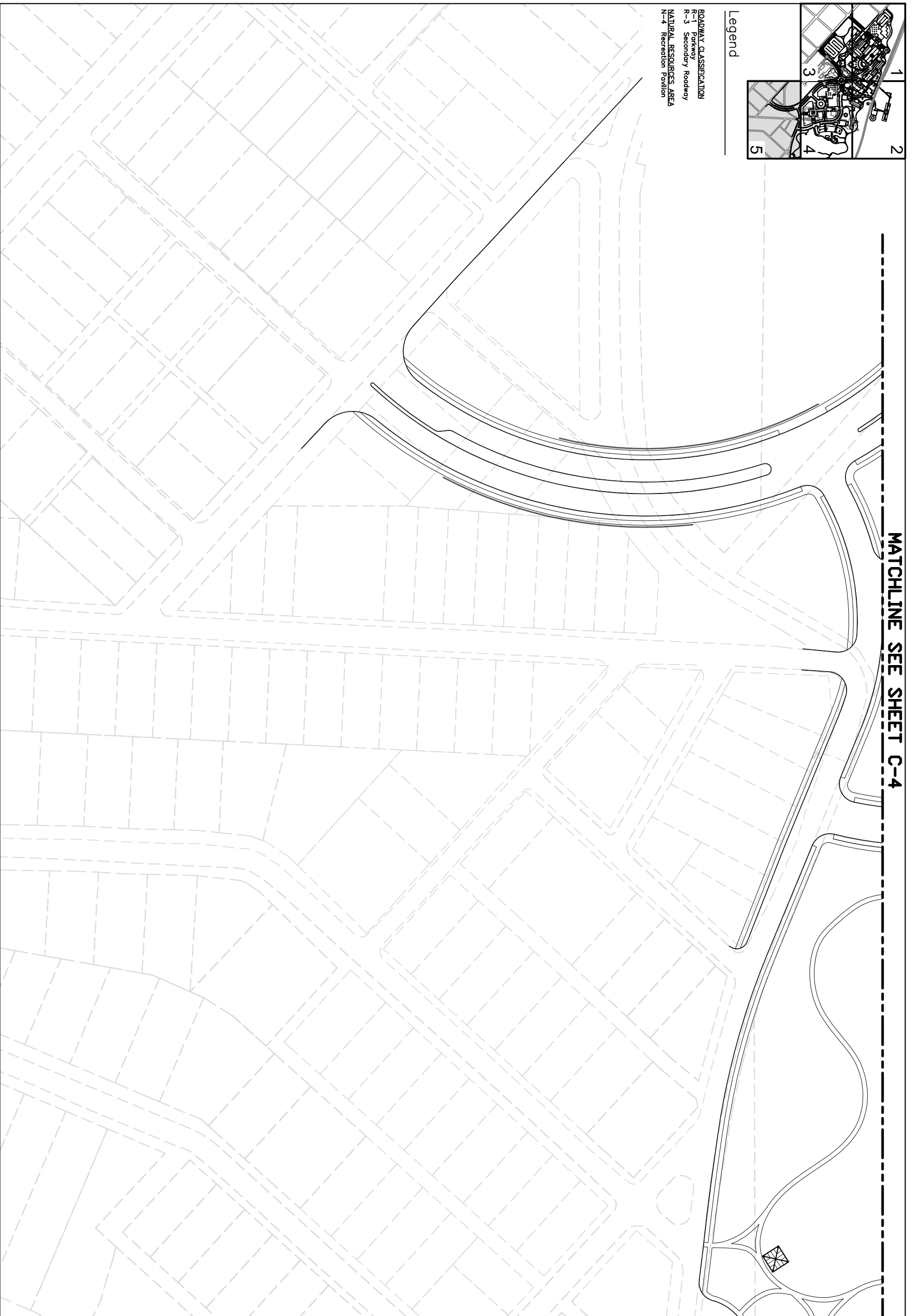

MATCHLINE SEE SHEET C-4

DATE: November 2005
 REVISIONS:

Prepared by:

PARSONS

400 Woods Mill Road South, Suite 300
 St. Louis, Missouri 63017-3427
 In Association with:
 Development Strategies, Inc.
 Trivers Associates, Inc.
 TSI Engineering, Inc.
 William Tao & Associates, Inc.
 George Dickie Associates

State of Missouri

MATT BLUNT, GOVERNOR

Office of Administration
 Division of Facilities Management,
 Design and Construction
 David L. Mosby, CFM, Director

MSP Redevelopment Commission

Room 730, Truman Building
 P.O. Box 809
 Jefferson City, Missouri 65102

SITE PLAN

MSP REDEVELOPMENT PROJECT

JEFFERSON CITY, MISSOURI

PROJECT NUMBER: C 0020-01
 PARSONS PROJECT NUMBER: 738538

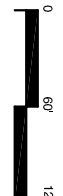
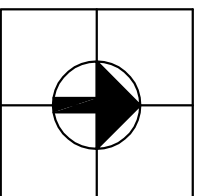

SHEET:

C-5

MATCHLINE SEE SHEET C-1



MATCHLINE SEE SHEET C-4

Legend

- MSP HISTORIC AREA
- H-2 Office Building (Housing Unit 2)
- H-9 Gas Chamber
- H-10 MSP Interpretive Garden
- H-11 Wall Penetration
- H-12 Guard Tower
- H-13 Remnant Wall
- H-14 Remnant Wall
- PUBLIC ASSEMBLY CAMPUS
- E-8 Public Assembly Facility
- Exhibition
- Auditorium
- Multi-Purpose
- Entry Plaza
- E-9
- OFFICE CAMPUS
- O-11 Office Building
- O-12 Water Feature
- PARKING
- P-2 Structured Parking

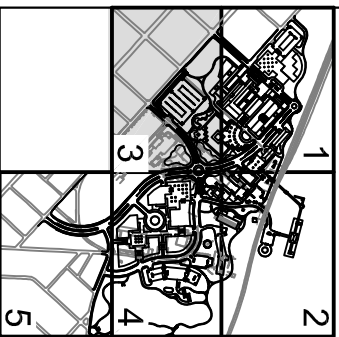

DATE: November 2005
REVISIONS:

Prepared by:
PARSONS
 400 Woods Mill Road South, Suite 300
 St. Louis, Missouri 63017-3427
 In Association with:
 Development Strategies, Inc.
 Trivers Associates, Inc.
 TSI Engineering, Inc.
 William Tao & Associates, Inc.
 George Dickie Associates

State of Missouri MATT BLUNT, GOVERNOR
 Office of Administration
 Division of Facilities Management,
 Design and Construction
 David L. Mosby, CFM, Director
 MSP Redevelopment Commission
 Room 730, Truman Building
 P.O. Box 809
 Jefferson City, Missouri 65102

SITE PLAN
 MSP REDEVELOPMENT PROJECT
 JEFFERSON CITY, MISSOURI
 PROJECT NUMBER: C 0020-01
 PARSONS PROJECT NUMBER 738538

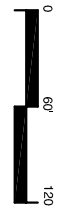
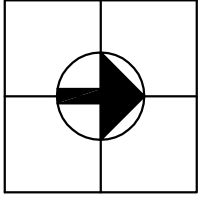

C-3
SHEET: